

SHARP SERVICE MANUAL

No. S47G1LC32D42U

SUPPLEMENT



LCD COLOR TELEVISION

LC-32D42U MODELS LC-32D43U

In the interests of user-safety (Required by safety regulations in some countries) the set should be restored to its original condition and only parts identical to those specified should be used.

OUTLINE

In this Service Manual, only parts in the LCD module are shown. For the other points, refer to the LC-32D42U/LC-32D43U (S06X9LC32D42U/SX6Y9LC37D43U) Service Manual.

New panel modules are incorporated in LC-32D42U/LC-32D43U with the Serial No. "****51112~".

How to distinguish the model labels of new and old panel modules.

As to the new panel module, the mark **A** is printed on the model label.

Old panel module

No **A** mark on the right side of the model name

Example

SHARP
LIQUID CRYSTAL TV
MODEL LC-32D42U
MODELE LC-32D42U
120V ~ 60Hz 175W

NOM 1245
NYCE

UL US
LISTED
TV EQUIPMENT
86BW

FC

CAUTION
RISK OF ELECTRIC SHOCK
DO NOT OPEN

ATTENTION
RISQUE DE CHOC ELECTRIQUE
NE PAS OUVRI

No Mark

SHARP CORPORATION
TECHNICAL DESIGN BY SHARP JAPAN
ASSEMBLED IN MEXICO BY SHARP
DESIGN TECHNIQUE PAR SHARP JAPON
ASSEMBLE AU MEXIQUE PAR SHARP

New panel module

A mark on the right side of the model name

Example

SHARP
LIQUID CRYSTAL TV
MODEL LC-32D42U
MODELE LC-32D42U
120V ~ 60Hz 175W

NOM 1245
NYCE

UL US
LISTED
TV EQUIPMENT
86BW

FC

CAUTION
RISK OF ELECTRIC SHOCK
DO NOT OPEN

ATTENTION
RISQUE DE CHOC ELECTRIQUE
NE PAS OUVRI

A

SHARP CORPORATION
TECHNICAL DESIGN BY SHARP JAPAN
ASSEMBLED IN MEXICO BY SHARP
DESIGN TECHNIQUE PAR SHARP JAPON
ASSEMBLE AU MEXIQUE PAR SHARP

Parts marked with "⚠" are important for maintaining the safety of the set. Be sure to replace these parts with specified ones for maintaining the safety and performance of the set.

OUTLINE AND ADJUSTMENT

[1] Outline

In this Service Manual, only parts in the LCD module are shown. For the other points, refer to the LC-32D42U/LC-32D43U (S06X9LC32D42U/SX6Y9LC37D43U) Service Manual.

New panel modules are incorporated in LC-32D42U/LC-32D43U with the Serial No. "****51112~".

How to distinguish the model labels of new and old panel modules.

As to the new panel module, the mark **A** is printed on the model label.

Old panel module

No **A** mark on the right side of the model name

Example

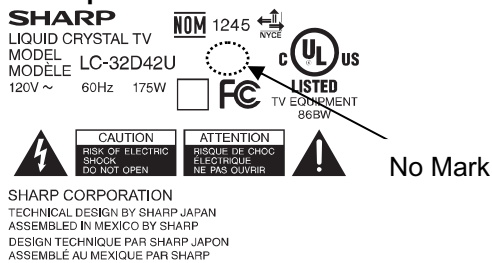

New panel module

A mark on the right side of the model name

Example

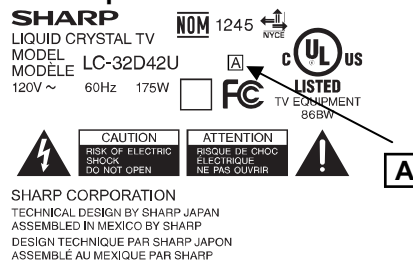

[2] Adjustment

When replacing the LCD control PCB, follow these steps to adjust VCOM.

- 1) Remove the wire from the LCD control PCB CN3.
- 2) Connect a wire of the VCOM adjustment jig (electronic volume adjustment BOX) to CN3 (see Fig. 1).
- 3) Turn on the TV set.
- 4) Turn on the jig (connect to the AC).
- 5) Enter the process mode to display the item "LCD TEST PATTERN OFF" (see Fig. 2).
- 6) Press the volume up key once to display a flicker pattern.
- 7) Press the jig's UP/DOWN switch while looking at the screen to adjust the point so that the flicker is minimized (see Fig. 3).
- 8) After completing adjustment, press the WRITE switch and make sure the lamp of the WRITE button goes out. (Writing is complete when the lamp goes out.)
- 9) Turn off the jig (turn the AC off).
- 10) Turn off the TV set.
- 11) Remove the jig's wire connected to CN3.
- 12) Reconnect the wire of the set to CN3.

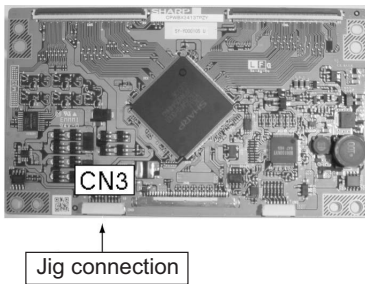

Fig. 1 Jig connecting location



Fig. 2 Test pattern selection screen

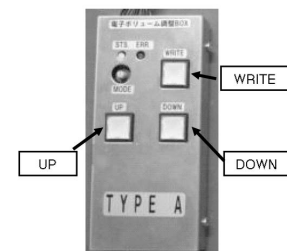

Fig. 3 VCOM adjustment jig (RUNTZA059WJZZ)

SHARP PARTS GUIDE



LCD COLOR TELEVISION

LC-32D42U

MODELS LC-32D43U

CONTENTS

[1] LCD MODULE Assembly

Parts marked with "△" are important for maintaining the safety of the set. Be sure to replace these parts with specified ones for maintaining the safety and performance of the set.

[1] LCD MODULE Assembly

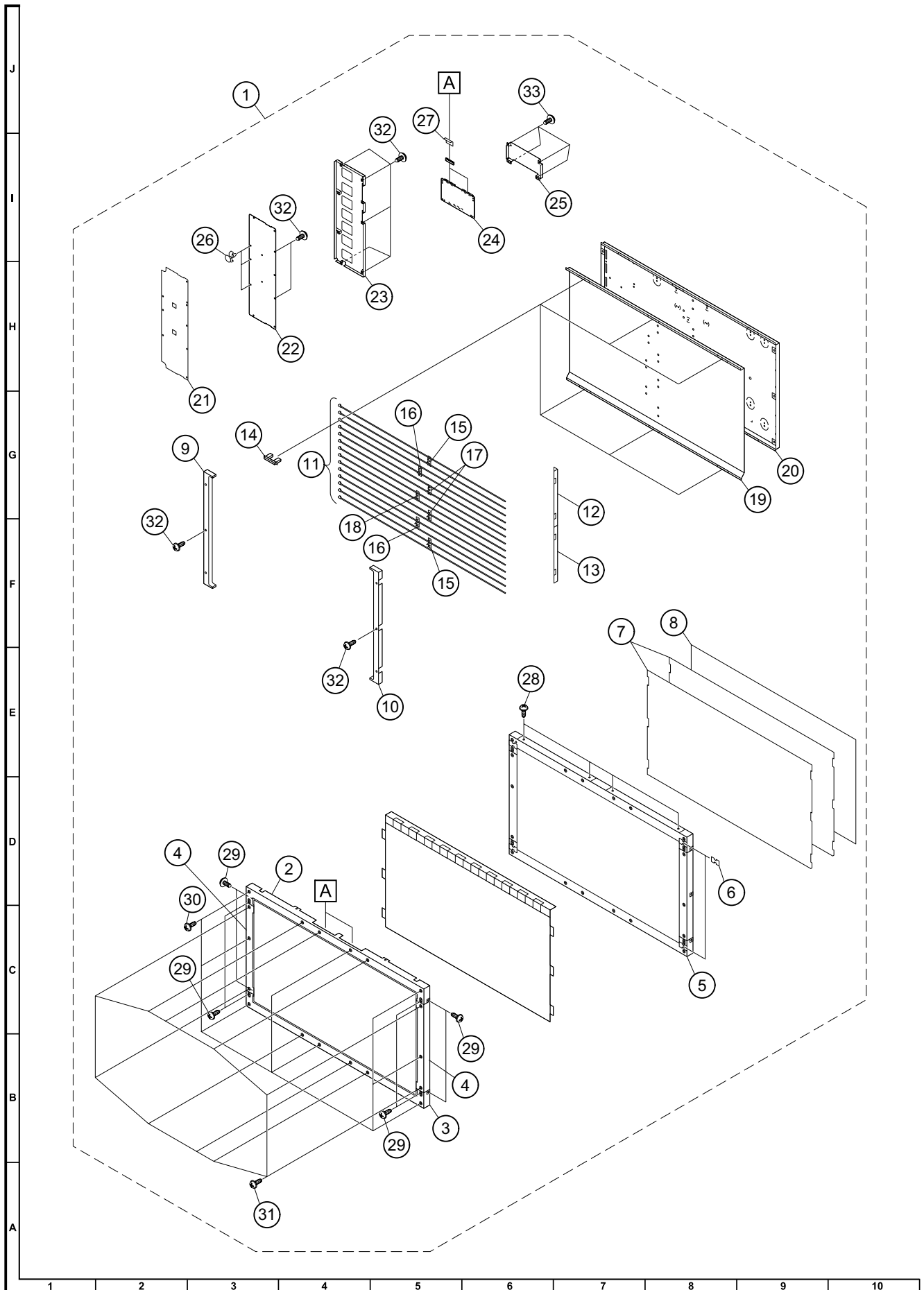

NO.	PARTS CODE	PRICE RANK	NEW MARK	PART DELIVERY	DESCRIPTION
[1] LCD MODULE Assembly					
1	R1LK315T3LZ50Z	EE	N	J	LCD Module Ass'y
2	CANGTA272WJ01	AW	N	J	Vessel (Top)
3	CANGTA272WJ02	AW	N	J	Vessel (Bottom)
4	CANGTA273WJ01	AP	N	J	Vessel (L, R), x2
5	CHLDZA697WJ01	BC	N	J	Panel Holder Ass'y
6	CHLDZA692WJ01	AD	N	J	Spacer Ass'y, x2
7	PSLDK2673TPGZ		N	J	Reflection Sheet, x2
8	PSLDK2676TPGZ		N	J	Diffusion Panel
9	CHLDZ3419TP01	AQ	N	J	Lamp Holder-L
10	CHLDZ3418TP01		N	J	Lamp Holder-R
11	CLMPCA002WJ02		N	J	Lamp Unit, x7
12	LHLDZ3421TPZZ		N	J	Lamp Holder (Bottom-A)
13	LHLDZ3420TPZZ		N	J	Lamp Holder (Bottom-B)
14	LHLDZA709WJKZ	AC		J	Sheet Holder, x6
15	LHLDZ3416TPZZ		N	J	Lamp clip A, x2
16	LHLDZ3417TPZZ		N	J	Lamp clip B, x2
17	LHLDZ3612TPZZ		N	J	Lamp clip C, x2
18	LHLDZ3613TPZZ		N	J	Lamp clip D
19	PREFL2391TPZZ	AR	N	J	Reflection Mirror
20	LANGK3717TPZZ		N	J	Chassis
21	PZETE3992TPZZ		N	J	Insulation Sheet
22	RDENC2299TPZZ		N	J	INVERTER Unit A
23	LANGK3718TPZZ		N	J	Shield Plate (for Inverter)
24	CPWBX3547TPZA	BR	N	J	LCD CONTROL Unit
25	PSLDMA893WJFW	AK	N	J	Shield Plate (for LCD CONTROL Unit)
26	PSPAZB030WJKZ	AB		J	Spacer, x3
27	QPWBMD670WJGZ		N	J	CS-FPC1, x2
28	LX-LZA101WJZZ	AC		J	Clip, x4
29	LX-BZ2102TPZZ	AB	N	J	Screw, x8
30	XEPS930P10000	AA		J	Screw, x8
31	XBPSN30P14000	AA		J	Screw, x10
32	XBPS730P06WS0	AA		J	Screw, x9
33	XBPS730P06000	AA		J	Screw, x4

SHARP

COPYRIGHT © 2007 BY SHARP CORPORATION

ALL RIGHTS RESERVED.

No Part of this publication may be reproduced, stored in a retrieval system, or transmitted in any form or by any means, electronic, mechanical, photocopying, recording, or otherwise, without prior written permission of the publisher.